



1120 North Main Street • Elkhart, IN 46514
 PHONE: 574•264•2131 FAX: 574•206•9713
 INTERNET: <http://www.atwoodmobile.com>

MPD 85392

BEVEL GEAR

Effective 11/21/07

Use on Electric Ball Screw Truck Camper Jacks

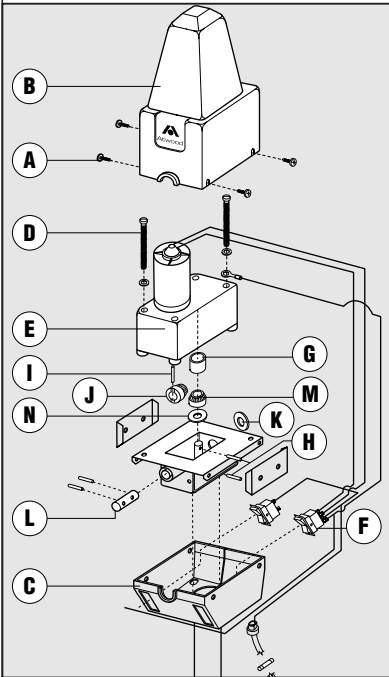

Atwood Electric Ball Screw Truck Camper Jacks are designed to be used in sets of four with one at each corner of the truck camper. The maximum lifting capacity is:

Ball Screw	System	Per Jack
	3900 lbs.	2200 lbs.

REMOVAL PROCEDURE

1. Disconnect electrical lead from jack to camper.
2. Remove four screws-A located on each side of cover-B. Remove top cover. Slide bottom portion of cover-C down jack leg.
3. Remove two screws-D attaching motor-E to jack. Disconnect two electrical wires on motor from switches-F. Lift motor off of jack.
4. Slide spacer-G off of screw shaft. Remove machine pin-H from shaft.
5. Using the manual overdrive handle, rotate vertical gear-J to an angle where groove pin can be driven out of gear. Drive groove pin-I out of gear using 1/8" punch.
6. Remove gear-J and washer-K from handle shaft-L.
7. Slide handle shaft out. Remove horizontal gear-M and washer-N from screw shaft.

For complete electric ball screw truck camper jack instructions consult MPD 87903.

continued backside



1120 North Main Street • Elkhart, IN 46514
 PHONE: 574•264•2131 FAX: 574•206•9713
 INTERNET: <http://www.atwoodmobile.com>

MPD 85392

BEVEL GEAR

Effective 11/21/07

Use on Electric Ball Screw Truck Camper Jacks

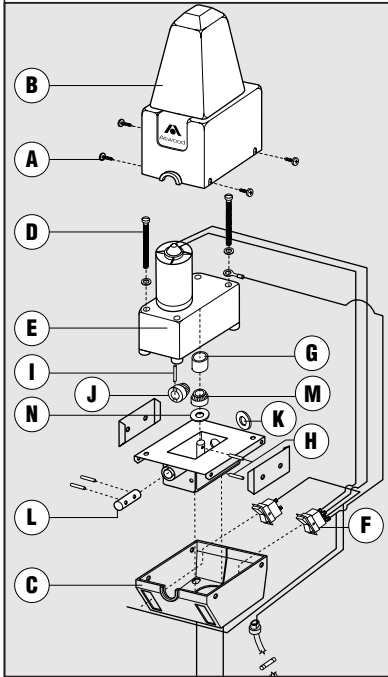

Atwood Electric Ball Screw Truck Camper Jacks are designed to be used in sets of four with one at each corner of the truck camper. The maximum lifting capacity is:

Ball Screw	System	Per Jack
	3900 lbs.	2200 lbs.

REMOVAL PROCEDURE

1. Disconnect electrical lead from jack to camper.
2. Remove four screws-A located on each side of cover-B. Remove top cover. Slide bottom portion of cover-C down jack leg.
3. Remove two screws-D attaching motor-E to jack. Disconnect two electrical wires on motor from switches-F. Lift motor off of jack.
4. Slide spacer-G off of screw shaft. Remove machine pin-H from shaft.
5. Using the manual overdrive handle, rotate vertical gear-J to an angle where groove pin can be driven out of gear. Drive groove pin-I out of gear using 1/8" punch.
6. Remove gear-J and washer-K from handle shaft-L.
7. Slide handle shaft out. Remove horizontal gear-M and washer-N from screw shaft.

For complete electric ball screw truck camper jack instructions consult MPD 87903.

continued backside



1120 North Main Street • Elkhart, IN 46514
 PHONE: 574•264•2131 FAX: 574•206•9713
 INTERNET: <http://www.atwoodmobile.com>

MPD 85392

BEVEL GEAR

Effective 11/21/07

Use on Electric Ball Screw Truck Camper Jacks

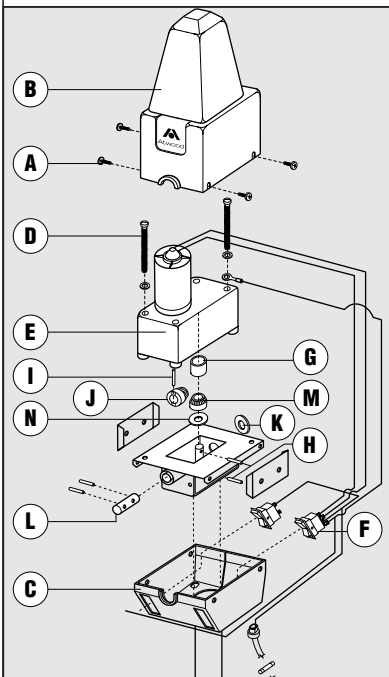

Atwood Electric Ball Screw Truck Camper Jacks are designed to be used in sets of four with one at each corner of the truck camper. The maximum lifting capacity is:

Ball Screw	System	Per Jack
	3900 lbs.	2200 lbs.

REMOVAL PROCEDURE

1. Disconnect electrical lead from jack to camper.
2. Remove four screws-A located on each side of cover-B. Remove top cover. Slide bottom portion of cover-C down jack leg.
3. Remove two screws-D attaching motor-E to jack. Disconnect two electrical wires on motor from switches-F. Lift motor off of jack.
4. Slide spacer-G off of screw shaft. Remove machine pin-H from shaft.
5. Using the manual overdrive handle, rotate vertical gear-J to an angle where groove pin can be driven out of gear. Drive groove pin-I out of gear using 1/8" punch.
6. Remove gear-J and washer-K from handle shaft-L.
7. Slide handle shaft out. Remove horizontal gear-M and washer-N from screw shaft.

For complete electric ball screw truck camper jack instructions consult MPD 87903.

continued backside



1120 North Main Street • Elkhart, IN 46514
 PHONE: 574•264•2131 FAX: 574•206•9713
 INTERNET: <http://www.atwoodmobile.com>

MPD 85392

BEVEL GEAR

Effective 11/21/07

Use on Electric Ball Screw Truck Camper Jacks

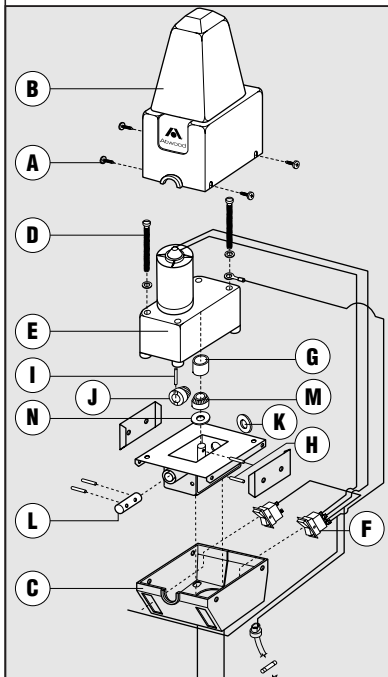

Atwood Electric Ball Screw Truck Camper Jacks are designed to be used in sets of four with one at each corner of the truck camper. The maximum lifting capacity is:

Ball Screw	System	Per Jack
	3900 lbs.	2200 lbs.

REMOVAL PROCEDURE

1. Disconnect electrical lead from jack to camper.
2. Remove four screws-A located on each side of cover-B. Remove top cover. Slide bottom portion of cover-C down jack leg.
3. Remove two screws-D attaching motor-E to jack. Disconnect two electrical wires on motor from switches-F. Lift motor off of jack.
4. Slide spacer-G off of screw shaft. Remove machine pin-H from shaft.
5. Using the manual overdrive handle, rotate vertical gear-J to an angle where groove pin can be driven out of gear. Drive groove pin-I out of gear using 1/8" punch.
6. Remove gear-J and washer-K from handle shaft-L.
7. Slide handle shaft out. Remove horizontal gear-M and washer-N from screw shaft.

For complete electric ball screw truck camper jack instructions consult MPD 87903.

continued backside

Effective 11/21/07

Use on Electric Ball Screw Truck Camper Jacks

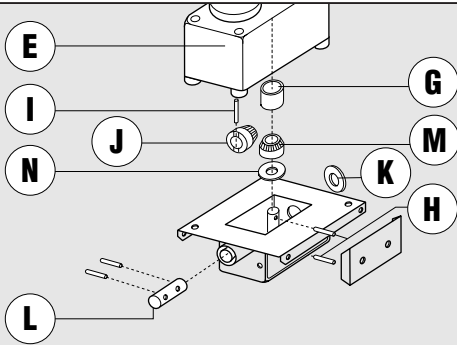

For complete electric ball screw truck camper jack instructions consult MPD 87903.

INSTALLATION PROCEDURE

1. Place washer-N on screw shaft. Insert machine pin-H in screw shaft. Align new gear-M with slot over machine pin and set in place on screw shaft.
2. Slide handle shaft-L into place. Place washer-K and new bevel gear-J onto shaft.
3. Insert groove pin-I into gear and through screw shaft. Replace spacer.
4. Thoroughly apply high pressure grease to gear teeth and turn crank handle to insure smooth travel.
5. Align motor shaft with groove pin in top of screw shaft. Rotate motor so that slots align with two threaded holes in mounting surface. Attach screws.
6. Reattach wires to motor switch.
7. Attach top and lower motor cover with four screws.

Effective 11/21/07

Use on Electric Ball Screw Truck Camper Jacks

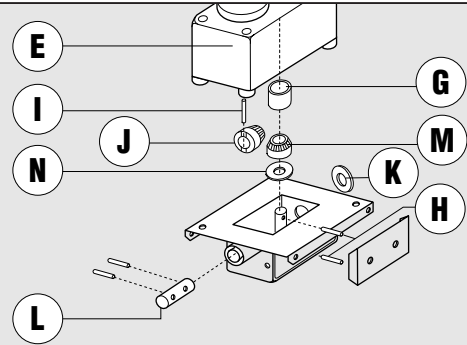

For complete electric ball screw truck camper jack instructions consult MPD 87903.

INSTALLATION PROCEDURE

1. Place washer-N on screw shaft. Insert machine pin-H in screw shaft. Align new gear-M with slot over machine pin and set in place on screw shaft.
2. Slide handle shaft-L into place. Place washer-K and new bevel gear-J onto shaft.
3. Insert groove pin-I into gear and through screw shaft. Replace spacer.
4. Thoroughly apply high pressure grease to gear teeth and turn crank handle to insure smooth travel.
5. Align motor shaft with groove pin in top of screw shaft. Rotate motor so that slots align with two threaded holes in mounting surface. Attach screws.
6. Reattach wires to motor switch.
7. Attach top and lower motor cover with four screws.

Effective 11/21/07

Use on Electric Ball Screw Truck Camper Jacks

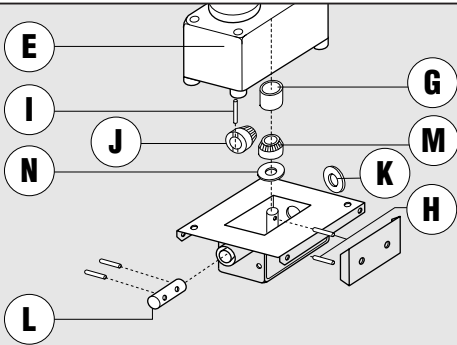

For complete electric ball screw truck camper jack instructions consult MPD 87903.

INSTALLATION PROCEDURE

1. Place washer-N on screw shaft. Insert machine pin-H in screw shaft. Align new gear-M with slot over machine pin and set in place on screw shaft.
2. Slide handle shaft-L into place. Place washer-K and new bevel gear-J onto shaft.
3. Insert groove pin-I into gear and through screw shaft. Replace spacer.
4. Thoroughly apply high pressure grease to gear teeth and turn crank handle to insure smooth travel.
5. Align motor shaft with groove pin in top of screw shaft. Rotate motor so that slots align with two threaded holes in mounting surface. Attach screws.
6. Reattach wires to motor switch.
7. Attach top and lower motor cover with four screws.

Effective 11/21/07

Use on Electric Ball Screw Truck Camper Jacks

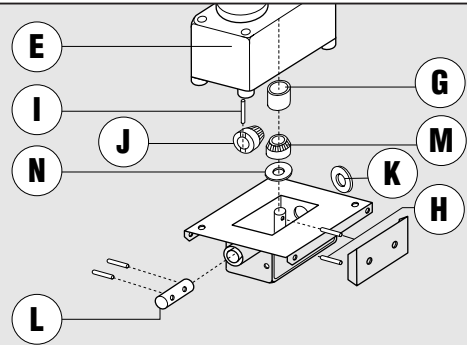

For complete electric ball screw truck camper jack instructions consult MPD 87903.

INSTALLATION PROCEDURE

1. Place washer-N on screw shaft. Insert machine pin-H in screw shaft. Align new gear-M with slot over machine pin and set in place on screw shaft.
2. Slide handle shaft-L into place. Place washer-K and new bevel gear-J onto shaft.
3. Insert groove pin-I into gear and through screw shaft. Replace spacer.
4. Thoroughly apply high pressure grease to gear teeth and turn crank handle to insure smooth travel.
5. Align motor shaft with groove pin in top of screw shaft. Rotate motor so that slots align with two threaded holes in mounting surface. Attach screws.
6. Reattach wires to motor switch.
7. Attach top and lower motor cover with four screws.